



**PRINCE DE GALLES**  
A LUXURY COLLECTION HOTEL

*Paris*

A legendary place capturing the essence of Parisian style, with gilded chandeliers, exquisite marble floors and unparalleled French hospitality.

### Accommodations

The exclusive 138 guest rooms and 30 suites of the Prince de Galles, a Luxury Collection Hotel offer indigenous Parisian design and intimacy in muted tones of royal blue and yellow Toile de Jouy. State-of-the-art details include a 32" LCD color cable and satellite television, Wifi connection and dual phone lines.

### Services & Features

Your stay at the hotel Prince de Galles will unfold with inspiring settings and magical services. In the true tradition of the Luxury Collection, the hotel offers 24-hour room service, concierge Clefs d'Or, a beauty salon, fitness center, full-service business center wireless high speed Internet access in all public areas, meeting facilities, and guest rooms.

### Meeting & Banquet Space

With a prime location in the heart of Paris, the Prince de Galles is the ideal place for your next meeting or special event. Our 5 meeting rooms can accommodate up to 200 attendees for every type of events - from high-level meetings to private celebrations. Our catering team is trained to provide support throughout your event and will ensure that your practical and technical needs are met.

### Local Attractions

The Prince de Galles is within walking distance of historical landmarks, including the Arc de Triomphe and the Champs-Élysées, and is located in the heart of Paris on Avenue George V. Experience the most beautiful avenue of the "City of Lights" and the exclusive local boutiques while discovering the exceptional treasures of Paris.



33 avenue George V  
75008 Paris  
France

tel +33 (0)1 53 23 77 77  
fax +33 (0)1 53 23 78 78

[luxurycollection.com/princedegalles](http://luxurycollection.com/princedegalles)

Ground Floor

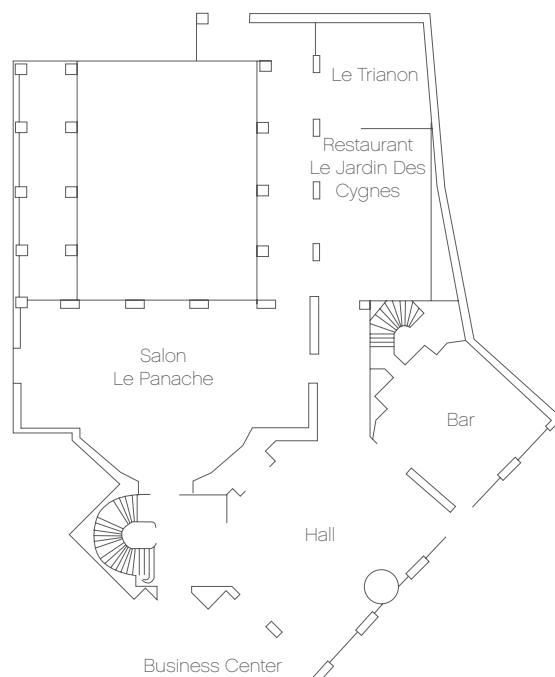

1<sup>st</sup> stage

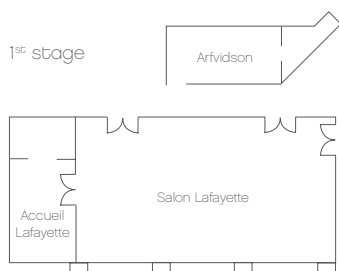

Lower level

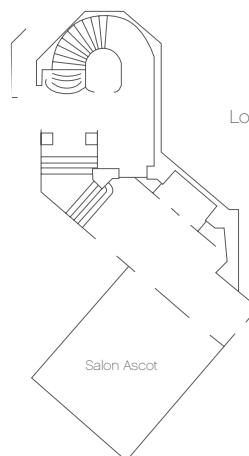

Floor plans

| ROOM      | LENGHT (m) | WIDTH (m) | HEIGHT (m) | TOTAL AREA (m <sup>2</sup> ) | THEATER | CLASSROOM | BANQUET | COCKTAIL | U  | BOARDROOM | CAPACITY  |
|-----------|------------|-----------|------------|------------------------------|---------|-----------|---------|----------|----|-----------|-----------|
| Panache   | 18.80      | 8.30      | 5          | 183                          | 200     | 100       | 150     | 200      | 60 | 60        | 60 to 200 |
| Lafayette | 14         | 7.30      | 2.60       | 102                          | 100     | 60        | 90      | 120      | 40 | 45        | 40 to 100 |
| Ascot     | 7.50       | 5.80      | 2.60       | 43                           | 32      | 20        | 30      | 40       | 24 | 22        | 10 to 30  |
| Giverny   | 7.75       | 5.60      | 2.60       | 44                           | -       | -         | 40      | 40       | 20 | 22        | 6 to 18   |
| Trianon   | 7          | 6.50      | 3.60       | 45                           | -       | -         | 40      | 40       | -  | -         | 10 to 30  |
| Arvidson  | 5          | 3         | 2.60       | 15                           | -       | -         | 6       | -        | -  | 10        | 2 to 10   |

1 m = 3,28 ft.  
1 m<sup>2</sup> = 10,76 sq. ft.